

21
25/3/26



OFFICE OF THE TAHASILDAR, DHENKANAL

No. 2125 /Gen & Misc Dt. 20/3/2026

E-mail Id: tah.dhenk-od@nic.in

Tel. No. 06762-226508

To

The BDO, Sadar, Dhenkanal

Sub:

Submission of Trace map and Land Particulars of sanctioned projects under BGBO Schemes.

Sir,

With reference to the letter on the subject cited above, I am to submit herewith the Trace map and Land Particulars submitted by concerned Revenue Inspectors for construction of the following 44 nos. of projects in respect of Dhenkanal Tahasil for taking necessary action at your end.

This is for favour of kind information and necessary action.

Enclosure: Trace map and Land Particulars

ofm c/kinmed, shy.
D.A. DW,

Yours faithfully

25/3/26
25/3/26
Tahasildar, Dhenkanal
Dhenkanal

25/3/26
25/3/26,

| SI No. | Name of Project | RI Office Letter/ Memo No. | Remark |
|--------|--|--|----------------|
| 1. | Construction of CC Road at Tainla Sahi Ward no.1 | Manipur R.I, Letter No. 126/ dtd.16.03.2026 | |
| 2. | Construction of CC Road ward no.06 Cremarorium to Kundi Chua | Manipur R.I, Letter No. 125/ dtd.16.03.2026 | |
| 3. ✓ | Construction of Bhoga Mandap at Hanuman Mandira Haridapasi | Bhapur R.I, Letter No. 103/ dtd.16.03.2026 | |
| 4. ✓ | Construction of Dola Mandap at Jatra Padia, Guhaladihi | Bhapur R.I Letter No. 103/ dtd.16.03.2026 | |
| 5. ✓ | Construction of Gopabandhu Youth Club building at Similipatana | Bhapur R.I Letter No. 103/ dtd.16.03.2026 | |
| 6. ✓ | Construction of open Mandap at Shiva Mandir Ichhapur | Bhapur R.I Letter No. 103/ dtd.16.03.2026 | |
| 7. ✓ | Construction of Gopal Samaj Community centre at Guhaladihi | Bhapur R.I Letter No. 103/ dtd.16.03.2026 | |
| 8 | Construction of community centre at Baniasahi | Bhapur R.I Letter No. 104/ dtd.16.03.2026 | |
| 9 | Construction of Bhoga Mandap at Raghunath Mandir | Bhapur R.I Letter No. 104/ dtd.16.03.2026 | |
| 10 | Construction of Bhoga Mandap at Bhapur Gopinath Mandir | Bhapur R.I Letter No. 104/ dtd.16.03.2026 | |
| 11 | Construction of CC Road from Hata Road to Shabar Sahi | Bhapur R.I Letter No. 104/ dtd.16.03.2026 | |
| 12 | Construction of Bhoga Mandap at Kamana Mandir | Beltikiri R.I Letter No. 166/ dtd.12.03.2026 | |
| 13 | Construction of Community Centre at Danda Ghara | Beltikiri R.I Letter No. 165/ dtd.12.03.2026 | |
| 14 | Construction of Kothaghara at Tala Sabar Sahi | Beltikiri R.I Letter No. 167/ dtd.12.03.2026 | |
| 15 | Construction of Bhoga Mandap Raghunathpur Siva at Raghunathpur | Chaulia R.I Letter No. 29/ dtd.18.03.2026 | Objection land |
| 16 | Construction of Motari Juanga Sahi Community Centre at Danda Ghara | Bhapur R.I Letter No. 109/ dtd.18.03.2026 | |
| 17. ✓ | Construction of Community Centre at Kuanali | Bhapur R.I Letter No. 109/ dtd.18.03.2026 | |
| 18. ✓ | Construction of Matha Sahi Community Centre at Koilipangi | Bhapur R.I Letter No. 109/ dtd.18.03.2026 | |
| 19. ✓ | Construction of CC Road from PWD Road to Akhila Khuntia House | Bhapur R.I Letter No. 109/ dtd.18.03.2026 | |
| 20. ✓ | Construction of Shani Mandap at Ragada Sahi | Bhapur R.I Letter No. 109/ dtd.18.03.2026 | |
| 21. ✓ | Construction of Bhoga Mandap at Shiba Mandir, Rajuapatana | Bhapur R.I Letter No. 109/ dtd.18.03.2026 | |

| | | | |
|------|--|---|--|
| 22 ✓ | Construction of Community Centre at Mahulaberani Harijan Sahi | Bhapur R.I Letter No. 109/ dtd.18.03.2026 | |
| 23 ✓ | Construction of CC Road at Motari UP School to canal | Bhapur R.I Letter No. 109/ dtd.18.03.2026 | |
| 24 | Construction of Chaulia Bidyanagar Sahi Mangala Mandir Bhoga Mandap | Chaulia R.I Letter No. 27/ dtd.18.03.2026 | |
| 25 | Construction of CC Road from Nagena Dola Mandap to Bada Jora | Chaulia R.I Letter No. 27/ dtd.18.03.2026 | |
| 26 | Construction of Kirtan Mandap/ Cultural Mandap at Bidyanagar Sahi | Chaulia R.I Letter No. 27/ dtd.18.03.2026 | |
| 27 | Construction of Tavapal Gopal Sahi Community Centre | Chaulia R.I Letter No. 27/ dtd.18.03.2026 | |
| 28 | Construction of CC Road from Tavapal Mandap to Ganesh Das House | Chaulia R.I Letter No. 27/ dtd.18.03.2026 | |
| 29 | Construction of CC Road from Gohirakhal Debadaru tree to PWD road | Kankadahad R.I Letter No. 127/ dtd.17.03.2026 | Consent of the concerned RTs may be obtained for construction of this project. |
| 30 | Construction of CC Road from Sapanisala to Santoshi Maa Mandira | Kankadahad R.I Letter No. 125/ dtd.17.03.2026 | |
| 31 | Construction of CC Road from Padia Chhaka to Post Office Kankadahad | Kankadahad R.I Letter No. 126/ dtd.17.03.2026 | |
| 32 | Construction of CC Road at Jankhira Juanga Sahi(Jankhira UP School to Juanga Sahi). | Beltikiri R.I Letter No. 177/ dtd.13.03.2026 | |
| 33 | Construction of Bhoga Mandap at Radhakrushna Mandir | Beltikiri R.I Letter No. 176/ dtd.13.03.2026 | |
| 34 | Construction of CC Road from Jagannath Barik House to Nibaran House | Kankadapal R.I Letter No. 97/ dtd.17.03.2026 | |
| 35 | Construction of CC Road from Dharmananda House to Pokhari | Kankadapal R.I Letter No. 98/ dtd.17.03.2026 | |
| 36 | Construction of Community Centre at Abhiram Matha of village Suakhaikateni | Kankadapal R.I Letter No. 99/ dtd.17.03.2026 | |
| 37 | Completion of Community Centre at Ranja | Kankadapal R.I Letter No. 100/ dtd.17.03.2026 | |
| 38 | Construction of Kamana Mandap at Ranja Harijan Sahi | Kankadapal R.I Letter No. 101/ dtd.17.03.2026 | |
| 39 ✓ | Construction of Jangya Mandap at Chandaneswar Shiva Mandir | Kankadapal R.I Letter No. 102/ dtd.17.03.2026 | |
| 40 ✓ | Construction of CC Road at Patana Sahi from Bhagaban Naik to Hemanta Barik house. | Kankadapal R.I Letter No. 103/ dtd.17.03.2026 | |
| 41 ✓ | Construction of open Mandap at Tarava Shani Mandir | Kankadapal R.I Letter No. 104/ dtd.17.03.2026 | |

| | | | |
|------|---|---|--|
| 42 ✓ | Construction of Bhagabat Tungi at Keutabereni | Kankadapal R.I Letter No. 105/ dtd.17.03.2026 | |
| 43 ✓ | Completion of Community Centre at Nimataila | Kankadapal R.I Letter No. 106/ dtd.17.03.2026 | |
| 44 | Construction of CC Road from Iswar Sahoo house to Nibaran Behera house. | Chaulia R.I Letter No. 28/ dtd.18.03.2026 | |

Tahasildar, Dhenkanal

OFFICE OF THE REVENUE INSPECTOR, CHAULIA

LETTER NO. 27 DT. 18/03/2026

To

The Tahasildar, Dhenkanal.

Sub: - (Submission of trace map and schedule of the sanctioned project Bikashita Gaon Bikashita Odisha 2025-26

Ref: - Tahasil letter no 1482 dt-23.02.2026

Sir,

In obedience to your letter regarding the aforementioned subject, I am submitting the trace map and land schedule for the sanctioned project under the scheme Bikashita Gaon Bikashita Odisha 2025-26

| Sl No | Gramapanchayat | Village | Project Name |
|-------|----------------|---------|---|
| 1 | Chaulia | Tavapal | Construction of CC Road from Tavapal Mandap to Ganesh Das House. |
| 2 | Chaulia | Chaulia | Construction Of Chaulia Bidyanagar Sahi Mangala Mandir Bhoga Mandap |
| 3 | Chaulia | haulia | Construction Of Kirtan Mandap/Cultural Mandap Bidyanagar Sahi |
| 4 | Chaulia | Tavapal | Construction Of Tavapal Gopal Sahi Community Center |
| 5 | Chaulia | Chaulia | Construction of CC Road from Nagen Dola mandap to Bada Jora |

This is for your kind information and necessary action.

Yours faithfully,

D. Panda
Revenue Inspector
Chaulia

Construction of CC road from Tavapal mandap to Ganesh das house

Mouza-Tavapal

P.S.-sadar

Dist-Dhekanal

| SL. No | AS Per Record | | | | | | As per Enquiry | | | | | |
|--------|-----------------|-----------------|---------|--------|---------|---|-----------------|---------|--------|---------|---------|--|
| | Name of the R.T | Khata No | Plot No | Kissam | Area | Purpose | Khata No | Plot No | Kissam | Area | Remarks | |
| 1 | 2 | 3 | 4 | 5 | 6 | 7 | 8 | 9 | 10 | 11 | 12 | |
| 1 | Govt. of Odisha | 119 (ଗଞ୍ଜାଧାରଣ) | 593 | ଗଞ୍ଜା | Ac 0.22 | Construction of CC road from Santoshi temple to Malabandha via Harijan sahi | 119 (ଗଞ୍ଜାଧାରଣ) | 593 | ଗଞ୍ଜା | Ac 0.22 | | |

 Revenue Inspector
Chaulia

15
5

ବୋଜା - ଟଭାଗାଲ
 ଥାନା - ବେଢ଼ାମାଳସୁନ୍ଦର ଛ ୧୧୧
 ବୃତ୍ତି - ବେଢ଼ାମାଳସୁନ୍ଦର ଛ ୩୧୪
 ଗ୍ରାମ - ବେଢ଼ାମାଳ
 ଗୋଟି - ୩୭ = ୧୩୭୦
 ମୂଲ୍ୟ - ୧୧୩ - ୮୪

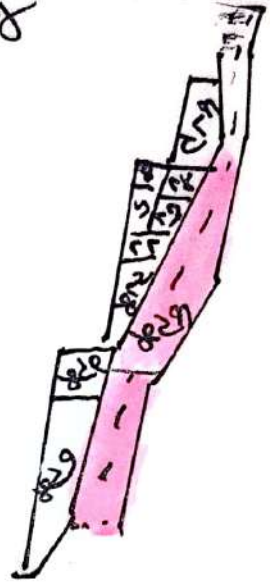

| | | | |
|---------------|---------------|-------------|--------------|
| ବୋଜା - ଟଭାଗାଲ | | | |
| <u>ଆଗାମୀ</u> | <u>କମ୍ପୂର</u> | <u>କମ୍ପ</u> | <u>ମୂଲ୍ୟ</u> |
| ୧୧୮ | ୫୮୩ | ୧୩୩ | ୧.୨୨ |

ସୁକ୍ଷ୍ମ ସମୀକ୍ଷା
 ଟଭାଗାଲ ସୂତ୍ରୀ ଶୁକ୍ଳ ଶରଣକଳ୍ୟାଣ

(Signature)
 17/07/2024

Revenue Inspector
 Chaulia